

Tech Guide

GR86/BRZ FA24 TVS1320 Supercharger



Harrop Engineering develops and manufactures premium supercharger kits for customers globally. Since 1955 Harrop have successfully designed and manufactured components for OEM's, Motorsport Teams, Car Builders and Enthusiasts. Harrop Engineering Australia and USA is certified to ISO 9001 standards with superior quality, performance and vehicle integration the foundation of Harrop Performance Products.



ENGINEERING PERFORMANCE SINCE 1955

Key features

- High efficiency TVS1320 supercharger technology
- Inverted supercharger provides more plenum volume before and after intercoolers
- No need to remove front bar, intercooler radiator fitted from bottom
- Supercharger kit retains OEM port and direct injectors
- One piece manifold / supercharger housing design
- Twin, dual pass high capacity water to air intercoolers
- Dual pass low temperature intercooler radiator
- High flow Bosch closed circuit intercooler pump
- Vehicle retains all OEM functionality
- Carbon fibre clean side airbox
- 85mm supercharger pulley (~8 PSI)
- No other vehicle modifications required
- Fits under stock bonnet
- Available in red or black
- Initially available as a tuner kit excluding EcuTek calibration
- USA market CARB EO application process pending

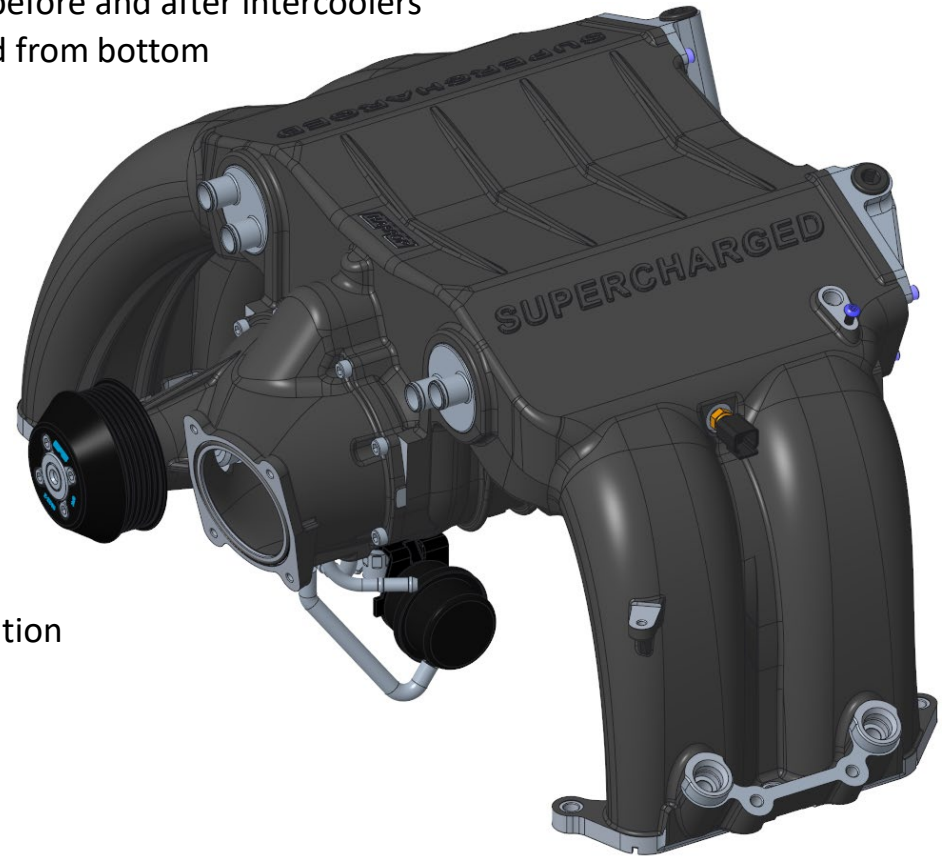

Engine bay integration

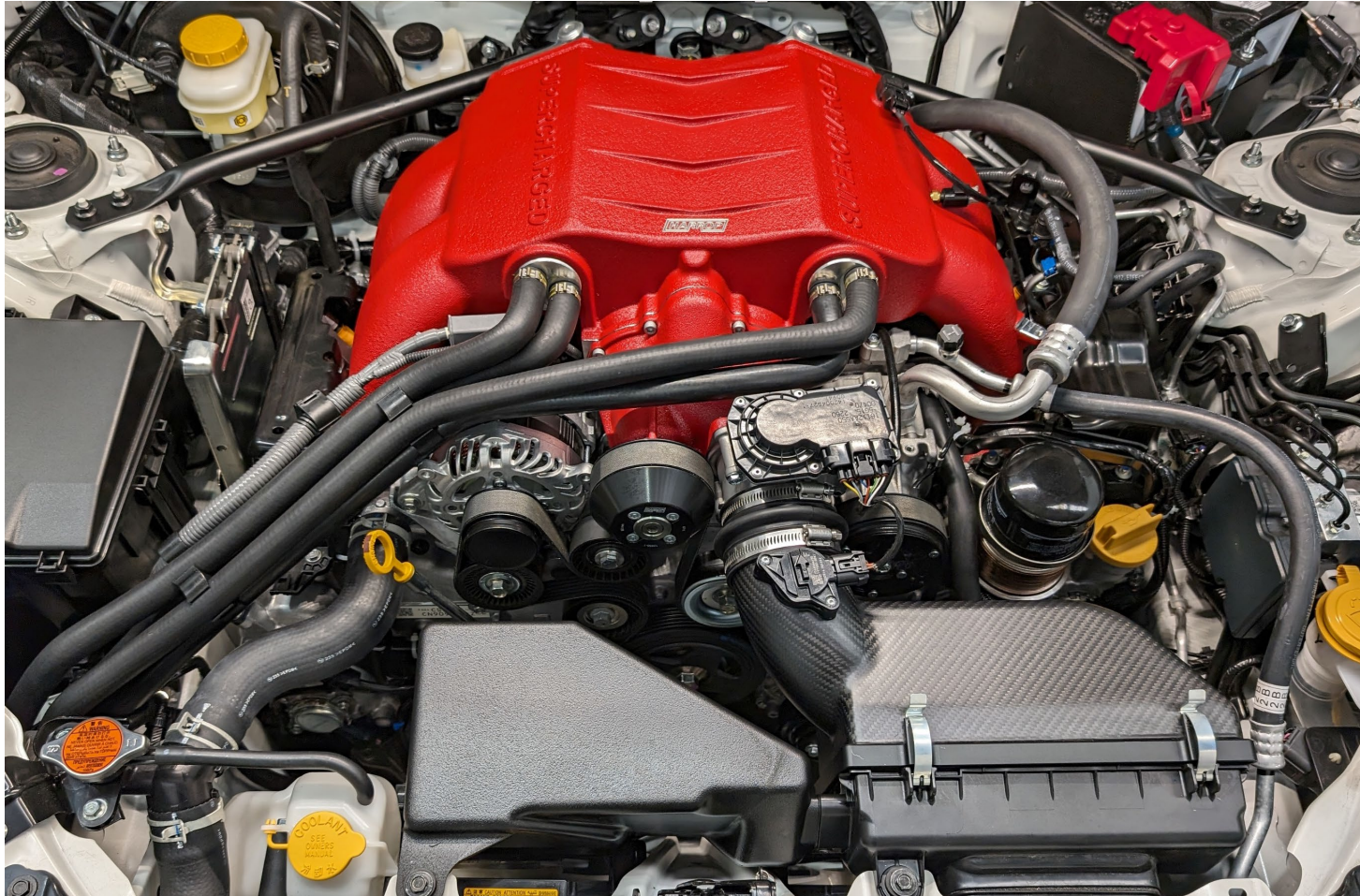

ENGINEERING PERFORMANCE SINCE 1955

Dimensions

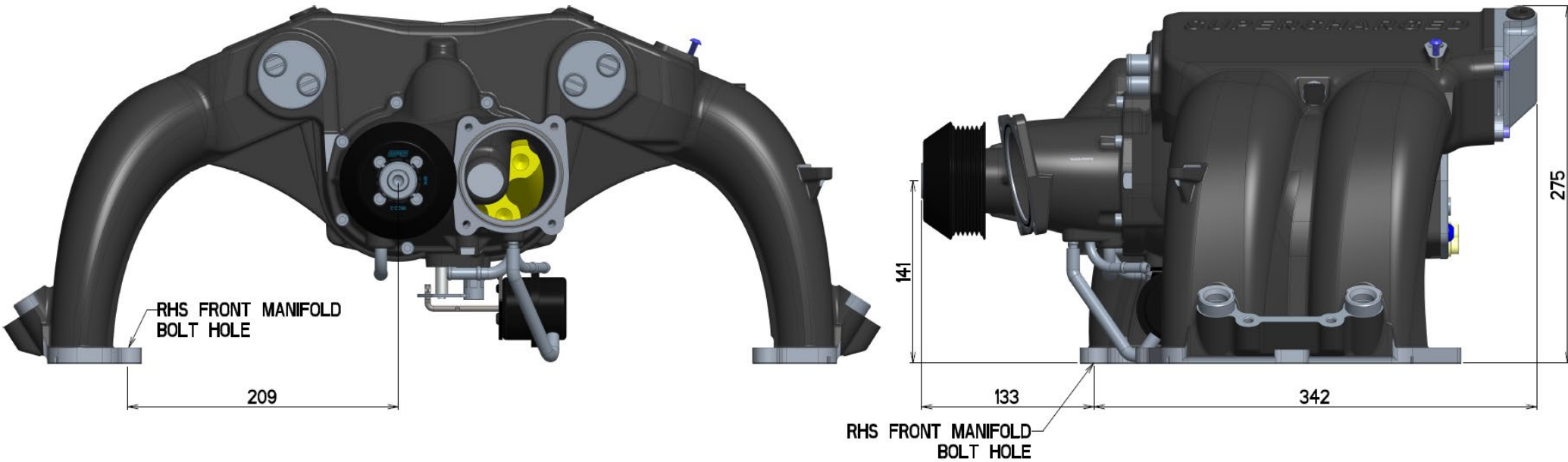

Exploded view

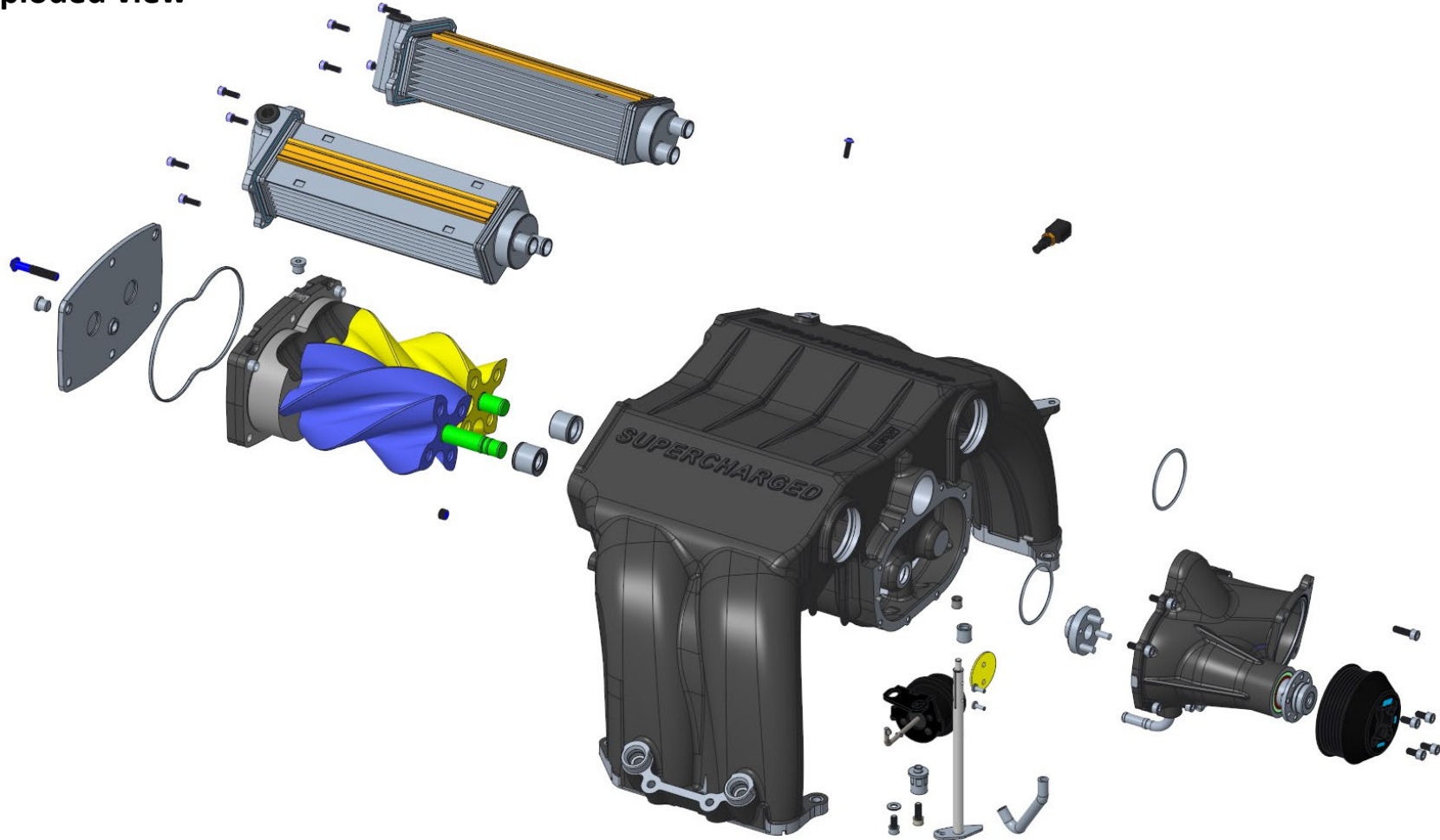

ENGINEERING PERFORMANCE SINCE 1955

Tech Guide

GR86/BRZ FA24 TVS1320 Supercharger



Intercooler layout

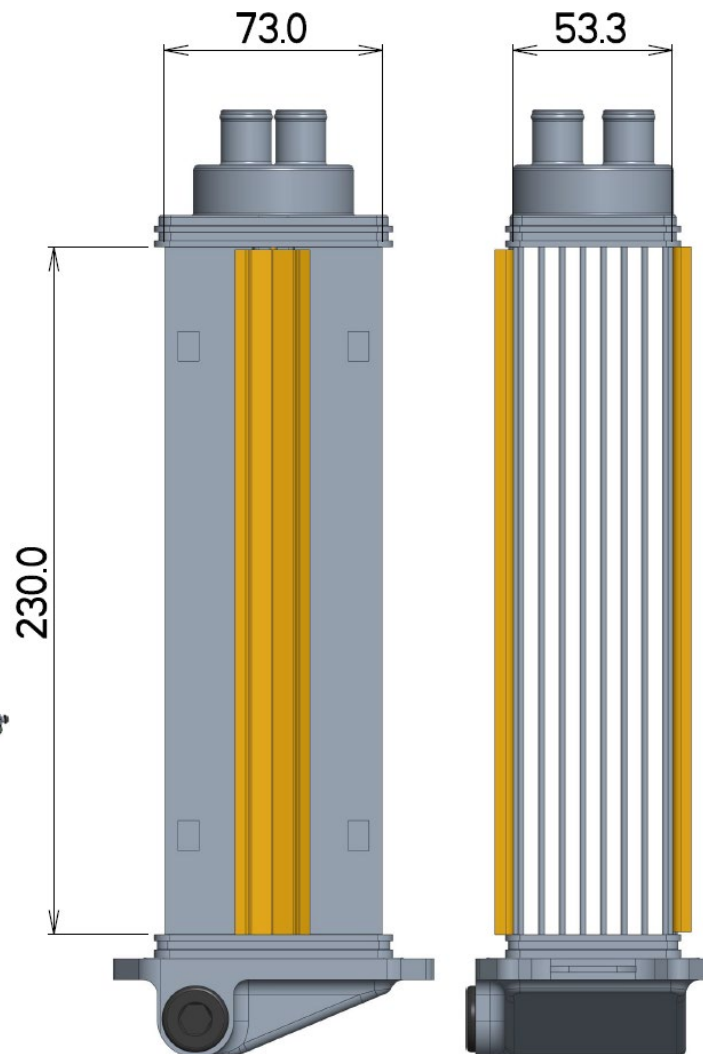
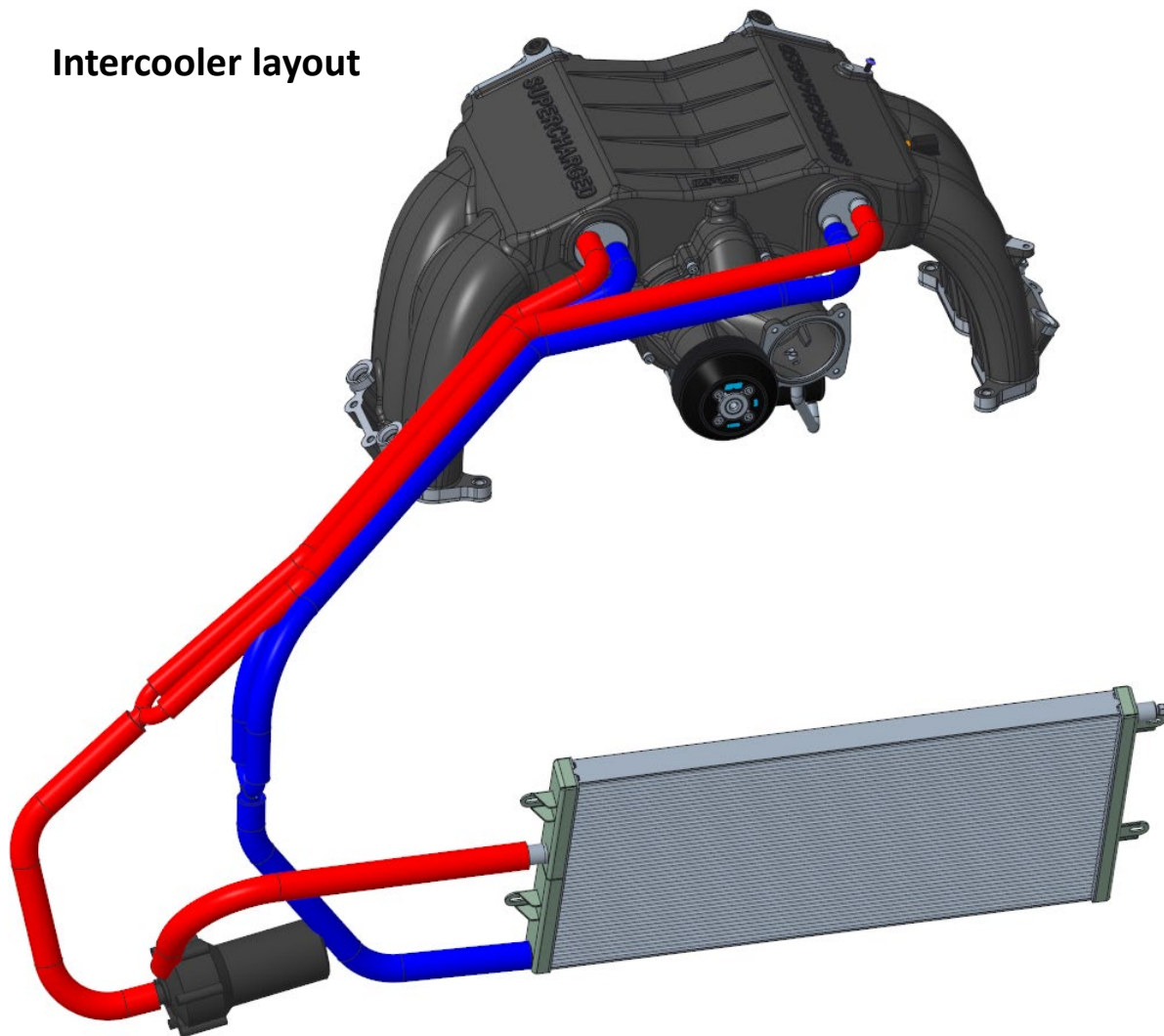

ENGINEERING PERFORMANCE SINCE 1955

6
04/04/2024

Performance

	Peak power	Peak torque	Peak boost
Naturally Aspirated FA24	160 kW (215 hp)	236 Nm (174 ft lb)	NA
Harrop Supercharged FA24	226 kW (303 hp) +41%	321 Nm (237 ft lb) +36%	~8 PSI

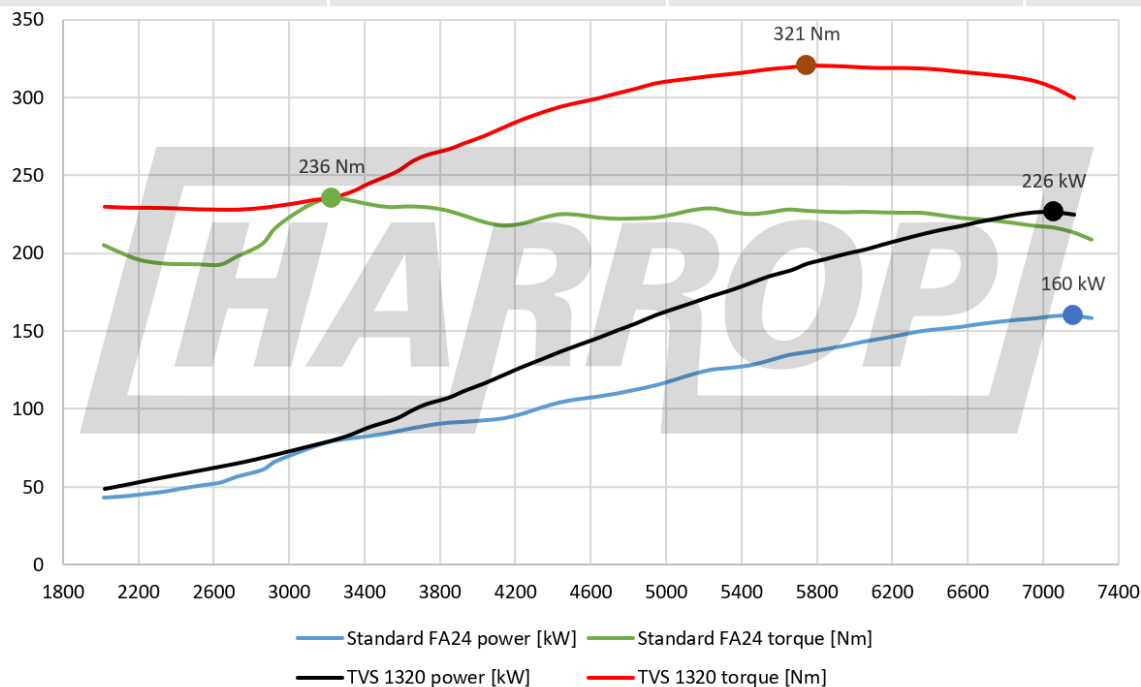

Measured on Mainline ProHub dyno running on 98 RON fuel at 20°C ambient temp

2023 GR86 test vehicle with no other modifications

Visit HarropTV to watch the Harrop supercharged Toyota GR86 - <https://youtu.be/CuWHOVeW2Oo>

ENGINEERING PERFORMANCE SINCE 1955