

Harrop Engineering develops and manufactures premium supercharger kits in Melbourne, Australia. Through 60 years of automotive performance Engineering, Harrop Engineering have successfully manufactured and supplied Superchargers to Automotive OEM programmes including TRD, Lotus Cars and Ford Australia. Harrop Engineering is certified to meet ISO 9001 standards of quality. OEM Quality, performance and vehicle integration are the foundation of Harrop Supercharger kits.

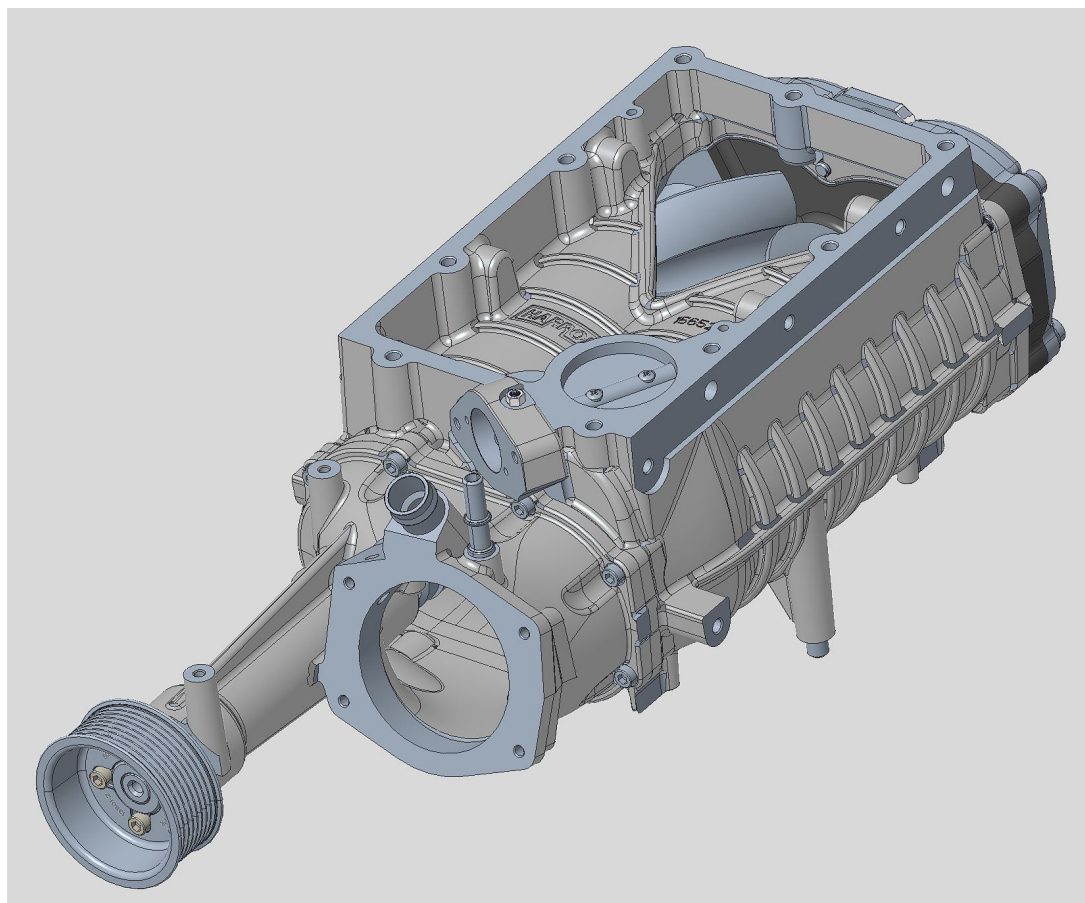

ENGINEERING PERFORMANCE SINCE 1955

JUL 2023 - Rev 0

Overview:

Harrop FDFI TVS2300 Supercharger kit is designed for the 5.0 Supercharged AJV8 fitted to JAGUAR and RANGE ROVER with electronic bypass actuator sensor, as a factory replacement.



ENGINEERING PERFORMANCE SINCE 1955

Key Features:

- Eaton TVS2300 Supercharger technology
- Integrated Supercharger Bypass system which relieves boost under light load conditions, reducing drive loss and improving fuel economy
- A direct bolt in replacement for the OEM Eaton 1900 Supercharger
- Retains all OEM accessories, Air Intake, Throttle Body, 8DPK belt, tensioner, and idler pulleys.



ENGINEERING PERFORMANCE SINCE 1955

Key Features:

- Eliminates the Factory OEM coupler – prone to fatigue
- No engine recalibration with the supplied 80mm supercharger pulley.
- Potential to increase power and boost with smaller supercharger pulleys (engine recalibration is required)

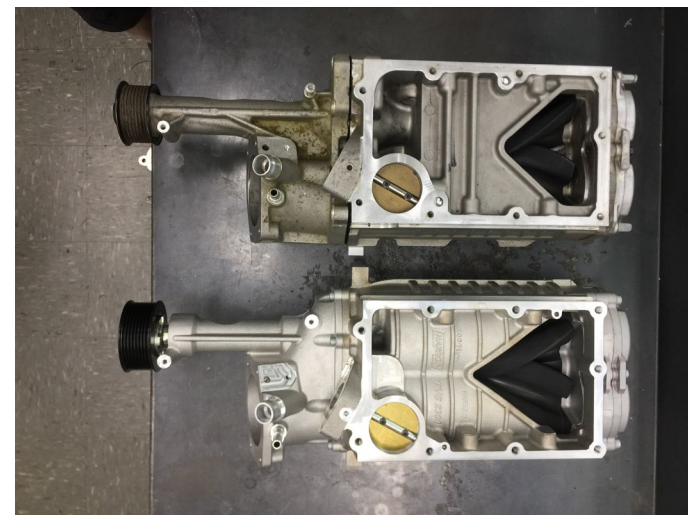
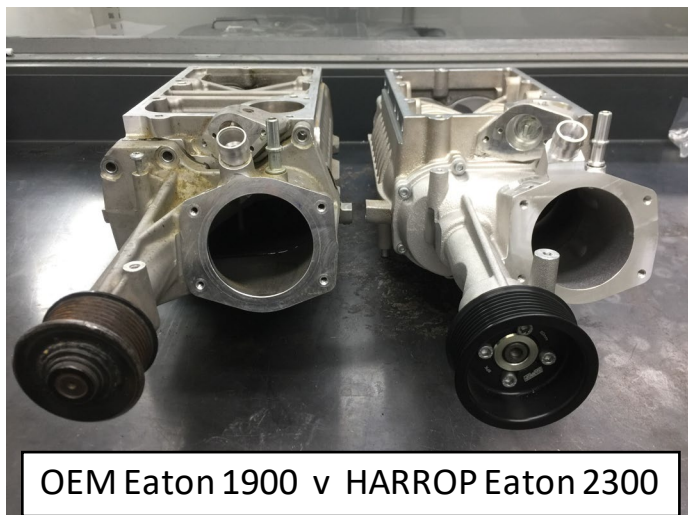

ENGINEERING PERFORMANCE SINCE 1955

Supercharger Pulley and Belt options

PULLEY P/No.	DESCRIPTION	BELT P/No.
99-PLY13808	Pulley, Supercharger, 8PK, Ø65.0 OD, 16.8 Offset	65-8DPK1412
99-PLY13809	Pulley, Supercharger, 8PK, Ø70.0 OD, 16.8 Offset	65-8DPK1412
99-PLY13810	Pulley, Supercharger, 8PK, Ø75.0 OD, 16.8 Offset	65-8DPK1412
99-PLY13801	Pulley, Supercharger, 8PK, Ø80.0 OD, 16.8 Offset	65-8DPK1412

LIST OF BELT PART NUMBERS FOR OEM FACTORY 65 DIA PULLEY.....
6080557, 8DK1412, 8DP1412, 8DPK1412, Dayco C2D39175, C2P12816, C2P12816X, DK080555

NOTE:- Pulleys listed in **RED** will require alternate HD tensioner pulley and idler pulley(s) combinations, and an engine re-calibration

What is supplied:

- Supercharger 2300 assembly
- Installation Guide

ITEM	DESCRIPTION	QTY	MATERIAL	FILENAME	AES63H
1	BEARING ROLLER, H1008 2RS, OPEN	1	AS SUPPLIED	HK_0008	H0009
2	BEARING ROLLER, H1004 2RS, OPEN, BRASS, METAL, EATON	1	AS SUPPLIED	BRG_ROLLER_BYPASS_T190T_E00706	E00706
3	BEARING ROLLER, T1927P220S, ROTOR, COBBLE, EATON	1	AS SUPPLIED	BEARING_T1927P220S_E00699	E00699
4	BEARING ROLLER, T1927P222, ROTOR, 40M37, EATON	1	AS SUPPLIED	BEARING_T1927P222_E00637	E00637
5	BUTTERFLY, BYPASS, SUPERCHARGER, TVS2300, JAGUAR AJ133	1	BRASS	BFLY_BYPASS_TV2300_AJ133_E00308	E00308
6	COUPLING-HUB ASSEMBLY, DRIVE HUB, COBBLE, EATON	1	AS SUPPLIED	COUPLING_HUB_DRIVE_HUB_E03308	E03308
7	COUPLING, RIBBY, FLEXIBLE, 40MM, EATON	1	AS SUPPLIED	COUPLING_FLEXIBLE_RIBBY_E00694	E00694
8	COVER, BEAR CASE, 2300, MODIFIED	1	AS SUPPLIED	CRK_CASE_2300_E00717	E00717
9	COVER, INLET, SUPERCHARGER, TVS2300, JAGUAR AJ133, ASSEMBLY	1	ROTOR TABLE	CRK_INLET_TV2300_AJ133_A0633	A0633-0
10	COVER, PIN, 2300 x 19, LONG	2	AS SUPPLIED	CRK_PIN	-
11	FASTENER, PIN HEAD, M4 x 27 x 16, HEXPT, EATON	2	AS SUPPLIED	FAST_BYPASS_T190T_M4X27_E00527	E00527
12	HOUSING, SUPERCHARGER, TVS2300, JAGUAR AJ133	1	AS SUPPLIED	HSG_SUPERCHARGER_TV2300_AJ133_E00210	E00210
13	NUT, HEX, M6 x 0.8, GEOMET500A	1	AS SUPPLIED	M6_M6_GEOMET500A	G02228
14	PLATE, BEARING ASSEMBLY, TVS2300, FOR, 40MM, EATON	1	-	BRG_PLT_ASM_FOR_TV2300_E03024	E03024
15	PLUG, FILLER, DL, HEX20, EATON	1	AS SUPPLIED	PLUG_FILLER_DL_20MM_E00220	E00220
16	VALVEY SUPERCHARGER, 190, 188, 0.00187, 4.40 PSD	1	HEXPT	PLT_2300V8_188_FOR_190V8	E00012
17	SCREW, SOCKET HEAD CAP, M6 x 20, ZINC PLATED, THREADLOCK COATED	4	AS SUPPLIED	SH_M6X20_ZP_THREADLOCK_R08	R08-0
18	SCREW, SOCKET HEAD CAP, M6 x 20, ZINC PLATED, THREADLOCK COATED	8	AS SUPPLIED	SH_M6X20_ZP_COATED_R065	R065-0
19	SCREW, SOCKET HEAD FLANGED, M6 x 40, THREADLOCK COATED	6	AS SUPPLIED	SHF_M6X40_0004_COATED	E00677
20	WFT SCREW, M6 x 16, CLIP POINT, SOCKET HEAD, GEOMET500A	1	AS SUPPLIED	SH_M6X16_GEOMET500A	E00643
21	SHAFT, BYPASS, TVS2300, AJ133	1	MILD STEEL	SHF_BYPASS_TV2300_AJ133_E00410	E00410



ENGINEERING PERFORMANCE SINCE 1955

Performance:

- Stock OEM supercharger as measured on Hub Dyno 398kW/656Nm Torque @9psi boost
- With Harrop 2300 supercharger – Power remains the same using the supplied Diameter 80 pulley

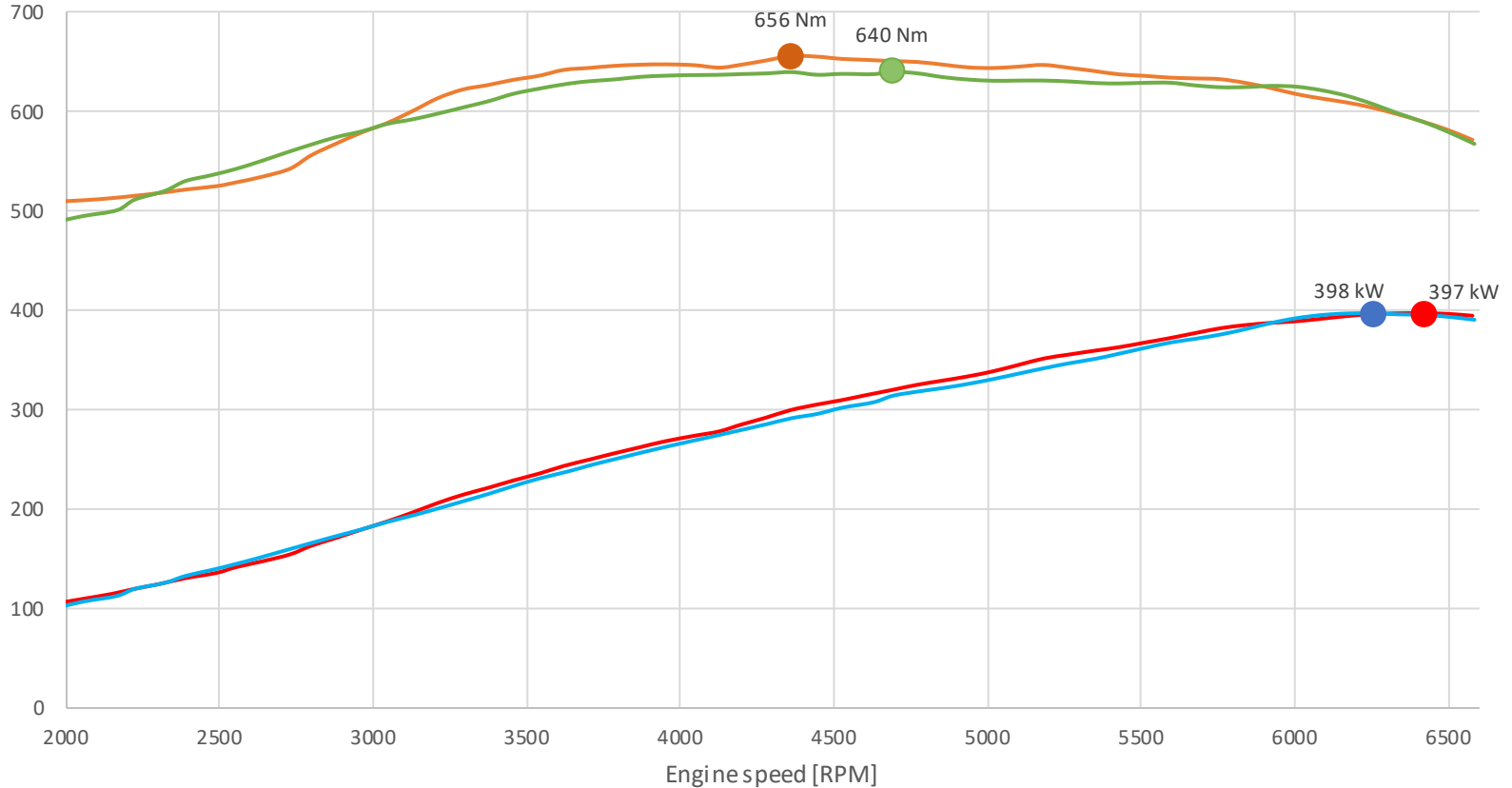

— Stock 1900 Power [kW] — Stock 1900 Torque [Nm] — 2300 80mm Power [kW] — 2300 80mm Torque [Nm]
● 2300 80mm Max power ● 2300 80mm Max torque ● Stock 1900 Max power ● Stock 1900 Max torque

ENGINEERING PERFORMANCE SINCE 1955

Installation:

- Takes approximately 8 hours
- Recalibration of the OEM ECU is not required with 80mm supercharger pulley.